

RYKER

PACKAGE HIGHLIGHTS

- Priced to excite
- Designed for fun
- Easy to ride
- 100 000 ways to make it your own



SPORT MODE / UFIT / ECO

	Rotax® 600 ACE™	Rotax® 900 ACE™
ENGINE		
Type	Rotax® 600 ACE™ in-line 2 cylinders, liquid-cooled with electronic fuel injection and electronic throttle control	Rotax® 900 ACE™ in-line 3 cylinders, liquid-cooled with electronic fuel injection and electronic throttle control
Bore & stroke	2.9 x 2.7 in. (74 x 69,7 mm)	2.9 x 2.7 in. (74 x 69,7 mm)
Power	50 hp (37.3 kW) @ 7300 RPM	82 hp (61.1 kW) @ 8000 RPM
Torque	36.7 ft-lb (49.7 Nm) @ 6000 RPM	58.3 ft-lb (79.1 Nm) @ 6500 RPM

TRANSMISSION	
Type	Automatic (CVT) with reverse function

CHASSIS	
Front suspension	Double wishbone
Front shocks type / travel	SACHS ¹ Twin-tube coil-over shocks / 5.39 in. (137 mm)
Rear suspension	Multi-link - mono swing arm
Rear shocks type / travel	SACHS ¹ Twin-tube coil-over shocks with preload adjustment / 5.91 in. (150 mm)
Electronic brake distribution system	Foot-operated, hydraulic 3-wheel brake
Front brakes	270 mm discs with Nissin 2-piston floating calipers
Rear brake	220 mm disc, 1-piston floating caliper
Parking brake	Park lock
Front tires	MC 145/60R16 66T
Rear tire	MC 205/45R16 77T
Aluminum front rims	5-spoke Carbon black, 16 x 4.5 in. (406 x 114 mm)
Aluminum rear rim	5-spoke Carbon black, 16 x 6.5 in. (406 x 165 mm)

CAPACITY	
Rider capacity	1
Maximum vehicle load	449.7 lb (204 kg)
Storage capacity	1.85 gal (7 L)
Fuel capacity	5.28 gal (20 L)
Fuel Type	Premium unleaded

	Rotax® 600 ACE™	Rotax® 900 ACE™
DIMENSIONS		
L x W x H	92.6 x 59.4 x 41.8 in. (2,352 x 1,509 x 1,062 mm)	
Wheelbase	67.3 in. (1,709 mm)	
Seat height	23.6 in. (599 mm)	23.5 in. (597 mm)
Ground clearance	4.1 in. (104 mm)	4.0 in. (102 mm)
Dry weight	594 lb (270 kg)	616 lb (280 kg)

INSTRUMENTATION		
Type	4.5" digital display	
Main Functions	Speedometer, tachometer, odometer, trips, distance to empty, engine lights, fuel gauge and clock	Speedometer, tachometer, odometer, trips, distance to empty, engine lights, fuel gauge, clock, ECO mode and Sport mode

SAFETY & SECURITY	
SCS	Stability Control System
TCS	Traction Control System
ABS	Anti-lock Braking System
Anti-theft system	Digitally Encoded Security System (D.E.S.S.™)
HHC	Hill Hold Control

COVERAGE	
Factory Warranty	1-year BRP Limited Warranty with 1-year roadside assistance
Extended Service Terms	B.E.S.T. terms available from 12 to 36 months with roadside assistance

FEATURES	
	2 halogen headlamps (55-W) Front fenders with integrated LED lights Dual USB port Glove box Adaptive foam waterproof seat

¹Only on Rotax 900 ACE Engine option

CLASSIC SERIES¹



Intense Black



Adrenaline Red



Yellow Shock



Carbon Black

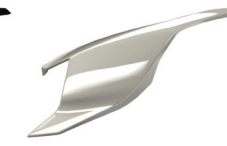

Immortal White



Liquid Steel

EXCLUSIVE SERIES²



Racer Red



Heritage White II



Liquid Titanium



Ruby Black



Urban Camo



Supersonic Green

FEATURE HIGHLIGHTS



AUTOMATIC TRANSMISSION (CVT)

No need to worry about changing gears as your continuously variable transmission will find the perfect combination of performance and fuel efficiency for you.

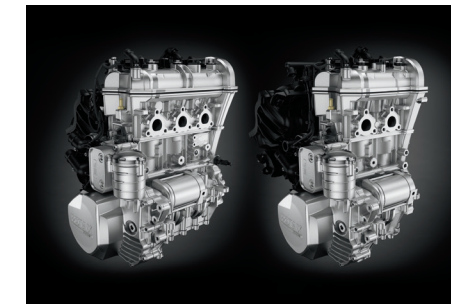

ENGINE OPTIONS

The 2-cylinder Rotax 600 ACE is the ultimate in accessible performance, while the 3-cylinder Rotax 900 ACE is the power & excitement standard of choice!



DRIVESHAFT

Highly durable and robust driveshaft technology will help you enjoy a smooth ride all along the way. No need for further adjustment, alignment or maintenance.



UFIT

Can be adjusted tool-free to fit the rider and provide a personalized and comfortable riding experience.



VSS

Vehicle Stability System that uses a variety of technologies, including SCS / ABS / TCS, to monitor the vehicle and keep the rider confident on the road.



CUSTOMIZATION

Can-Am Ryker was engineered to be almost infinitely customizable with 1 or 2-up options! Moments are all it takes to give it a transformation.

¹Choice of one set of Classic Panels included at the vehicle purchase. ²Exclusive Panel Kits are available in limited quantities.